

LOADING THE SURGICAL CASSETTE - GENERATION 02

(ART. NO. 1.03.030)

Prosthetic components (multiple use) & MONO insertion device for retentive anchors

May be cleaned in the sieve basket. A maximum of three prosthetic components and the MONO insertion device for retentive anchors may be cleaned at the same time. Sterilization is performed separately.

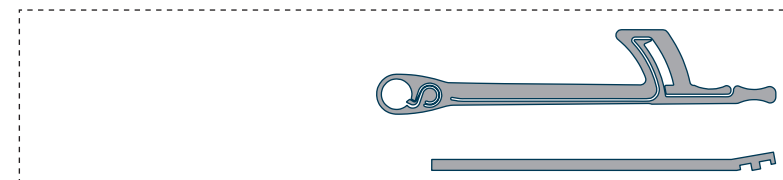
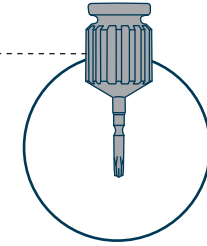
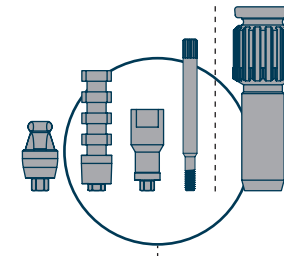

MONO torque ratchet

3.03.160

MONO guide key

3.03.203

MONO insertion device

3.03.162

MONO screwdriver

3.03.163

3.03.165

3.03.166

3.03.167

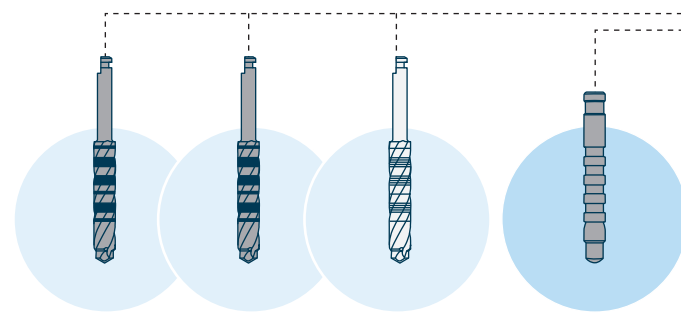
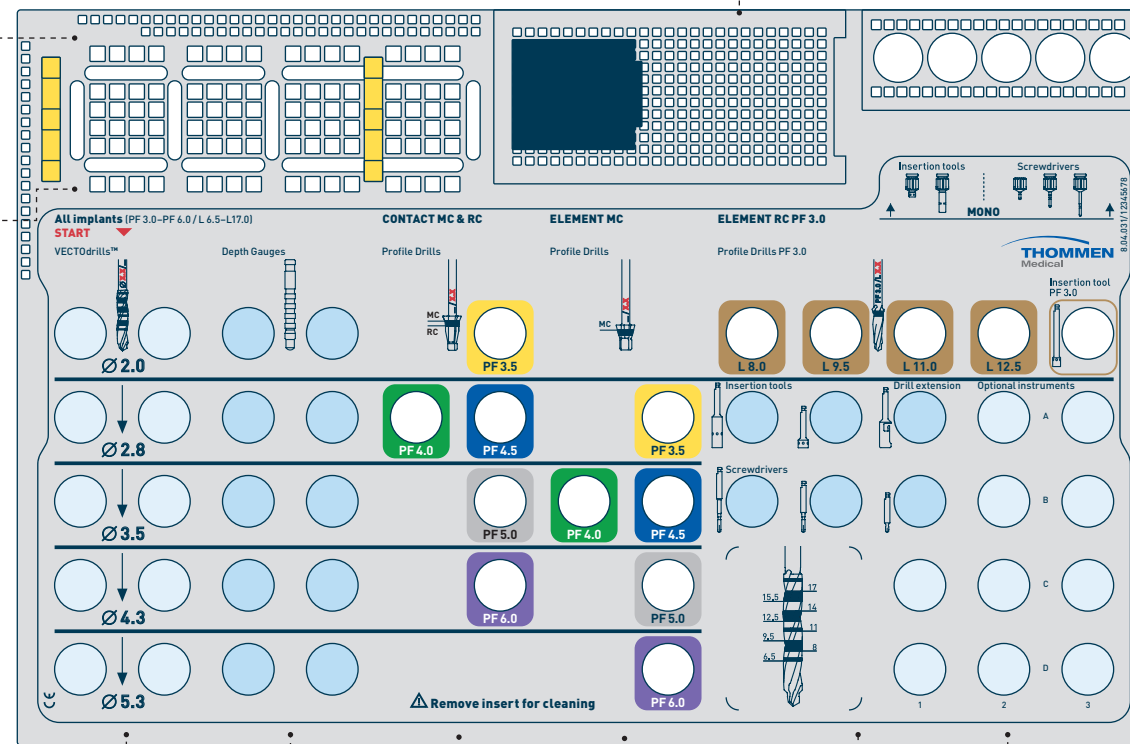

Single use



VECTodrill™ twist drill

Ø	Length	Steel, stainless	Steel, stainless	Ceramic
Ø 2.0	29.0	3.03.624 Q4	3.03.710	3.03.660
	34.0	3.03.610 Q4	3.03.720	3.03.661
	40.0	3.03.611 Q4	3.03.730	
Ø 2.8	29.0	3.03.625 Q4	3.03.712	3.03.662
	34.0	3.03.612 Q4	3.03.722	3.03.663
	40.0	3.03.613 Q4	3.03.733	
Ø 3.5	29.0	3.03.626 Q4	3.03.714	3.03.664
	34.0	3.03.614 Q4	3.03.724	3.03.665
	40.0	3.03.615 Q4	3.03.734	
Ø 4.3	29.0	3.03.627 Q4	3.03.716	3.03.666
	34.0	3.03.616 Q4	3.03.726	3.03.667
	40.0	3.03.617 Q4	3.03.736	
Ø 5.3	29.0	3.03.628 Q4	3.03.718	3.03.668
	34.0	3.03.618 Q4	3.03.728	3.03.669

Depth gauge

Ø 2.0	3.03.630
Ø 2.8	3.03.632
Ø 3.5	3.03.634
Ø 4.3	3.03.636
Ø 5.3	3.03.638

Profile drill CONTACT MC & RC

	3.03.640/641 Q4
3.03.648/649 Q4	3.03.642/643 Q4
	3.03.644/645 Q4
	3.03.646/647 Q4

Profile drill ELEMENT MC

	3.03.651 Q4
3.03.657 Q4	3.03.653 Q4
	3.03.655 Q4
	3.03.659 Q4

Instruments for mechanical use

Adapter		Drill extension
3.03.249	3.03.240	3.03.230/231
Screwdriver		
3.03.502/503	3.03.501/502	3.03.500/501

Optional

Along with the clearly designated slots, additional slots are provided that can be loaded as required.

ELEMENT RC PF 3.0

Profile drill, length-specific				Adapter
L 8.0	L 9.5	L 11.0	L 12.5	
3.03.740	3.03.741	3.03.742	3.03.743	3.03.238

When assigning drills, Ø **X.X** / **_**, pay attention to the first diameter stated on the shaft.



When assigning profile drills, **_** / **X.X**, pay attention to the second diameter stated on the platform.

